

# Noble Potentiometers

## AP25 (Single Element)

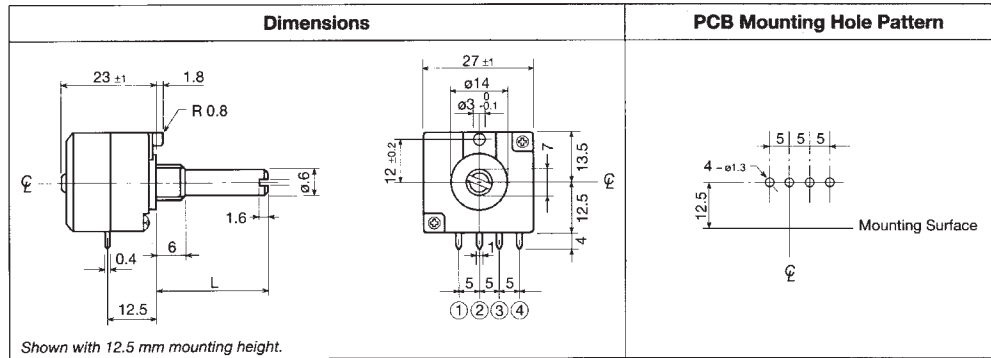

## AP25G (Dual Element)

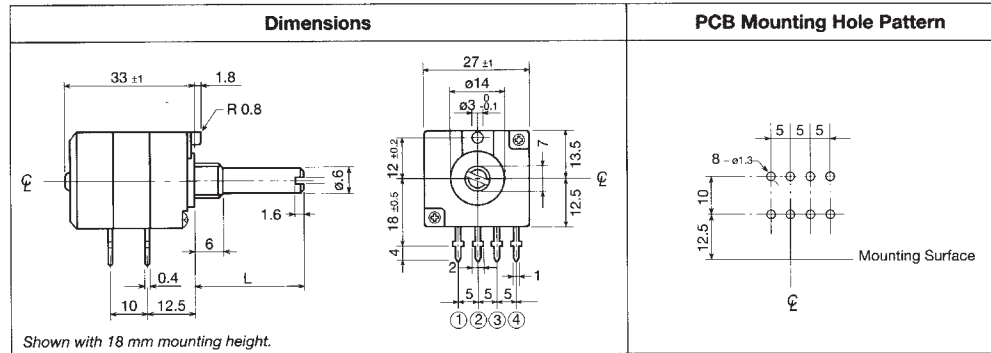

All dimensions are metric.

## SPECIFICATIONS

ELECTRICAL	
Total Resistance Range	10k $\Omega$ – 250k $\Omega$ (204Y, 210Y & 213Y Tapers) 25k $\Omega$ – 250k $\Omega$ (200Y & 211Y Tapers) 50k $\Omega$ – 250k $\Omega$ (203Y, 216Y & 217Y Tapers)
Tolerance of Total Resistance	±20%
Taper	See charts on following page
Power Rating	0.125W
Max. Operating Voltage	30V AC
Residual Resistance	3 $\Omega$ max.
Max. Attenuation Level for Volume Control	-90dB (Total Resistance Value $\geq$ 50k $\Omega$ ) -80dB (Total Resistance Value < 50k $\Omega$ )
Tracking Tolerance	0 – 70dB, $\pm$ 2dB (Total Resistance Value $\geq$ 50k $\Omega$ ) 0 – 60dB, $\pm$ 2dB (Total Resistance Value < 50k $\Omega$ )
MECHANICAL	
Total Rotation Angle	300° $\pm$ 3°
Rotational Torque	50 – 350 gf • cm
Detent Torque:	
Center Detent	Rotational torque + (30 to 200 gf • cm)
11, 21 and 31 Detent	100 – 400 gf • cm
Detent Angle:	
Center Detent	150° $\pm$ 2°
11 Position Detent	30° $\pm$ 2°
21 Position Detent	15° $\pm$ 2°
31 Position Detent	10° $\pm$ 2°
ENVIRONMENTAL	
Operating Temperature Range	-10°C to +70°C
Storage Temperature Range	-20°C to +80°C
Rotational Life	15,000 cycles (1 cycle = 720°)

## FEATURES

- Superb interchannel level tracking
- Low contact distortion
- Sealed to protect against solder flux infiltration
- High reliability
- Smooth operation
- Available in multiple detents

## APPLICATIONS

Ideal for Preampifiers and Power Amplifiers

- Master volume/level control
- Balance control

Distributed By:  
**Michael Percy Audio**  
 11731 Stillwater Creek Road  
 Nevada City, CA 95959  
 (530) 470-8650 (fax) 470-8651  
 <mpercy@pacbell.net>  
 www.percyaudio.com

## SHAFT STYLES

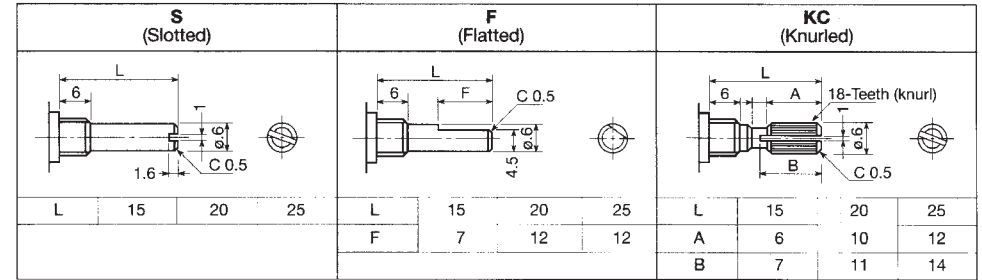

## STANDARD RESISTANCE TAPERS

### AUDIO

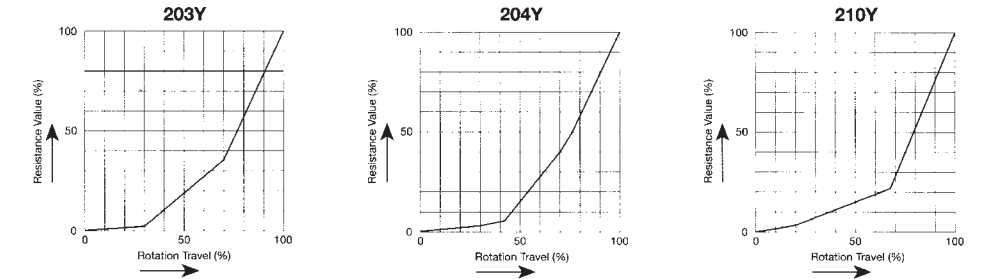

### LINEAR

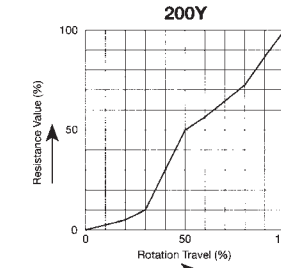

### REVERSE AUDIO

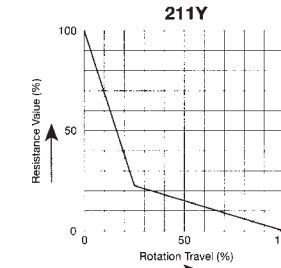

### BALANCE

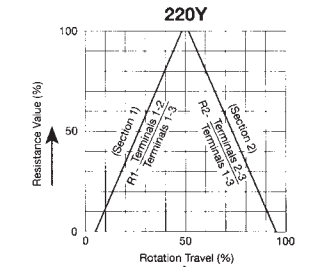
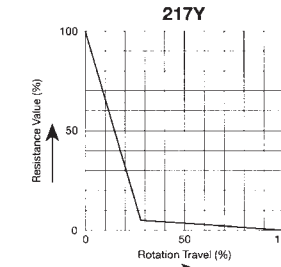
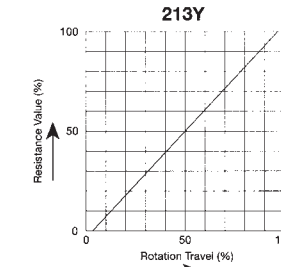
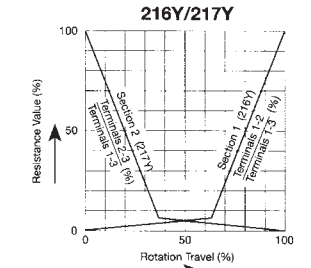

Other tapers available upon request, consult Noble.

# PART NUMBER EXAMPLE

1      2      3      4      -      5      6      -      7  
**AP25**   **G**   **PHDN**   **20F**   -   **204Y**   **50K x2**   -   **31PC**

## 1. Series

**AP25** — Hi-Grade Potentiometers

## 2. Element

- Single element
- G** — Dual element

## 3. Terminal Style

**PHDN** — 12.5 mm mounting height  
**PHAN** — 18 mm mounting height

*Refer to dimensional drawings.*

## 4. Shaft Length and Style

**15, 20 or 25** — Shaft length (mm)\*  
**S** — Slotted  
**F** — Flatted  
**KC** — Knurled

\* *Custom lengths available upon request*

## 5. Taper

*Refer to taper charts — State whether **200Y**, **203Y**, **204Y**, etc.*

## 6. Resistance Value

*Refer to specification charts,  
for dual element add: **x2***

## 7. Detent

— Without detent  
**CC** — Center detent  
**11PC** — 11 detents  
**21PC** — 21 detents  
**31PC** — 31 detents